

Top Quality Zinc Alloyed Mechanical Password Door Lock DH8805

Model Number:DH8805

Color:Silver

Material:Zinc alloy

Unlock ways:Code

Latch:Single latch

Weight:1.25KG

Door thickness requirement:> 40mm





How to change code of the 2th Generation lock

- 1.find the dot on the circle
- 2.Turn the dot toward the number
for example 14569,just turn the dot to
the number 14569
- 3.The new code is 14569





Home Door



Garage Door



Office



Classroom



Storeroom



Safety BOX



Attribute	Value
Material	Zinc alloy
password type	4-7 number
Appearance	pearl chrome, imitation
Door depth	30-70mm
Application scope	wooden doors, metal doors
Size	142*42*21mm
Working temperature	-20°C - 60°C
Working humidity	0%-95%



Scope Of Application

Official Accessories

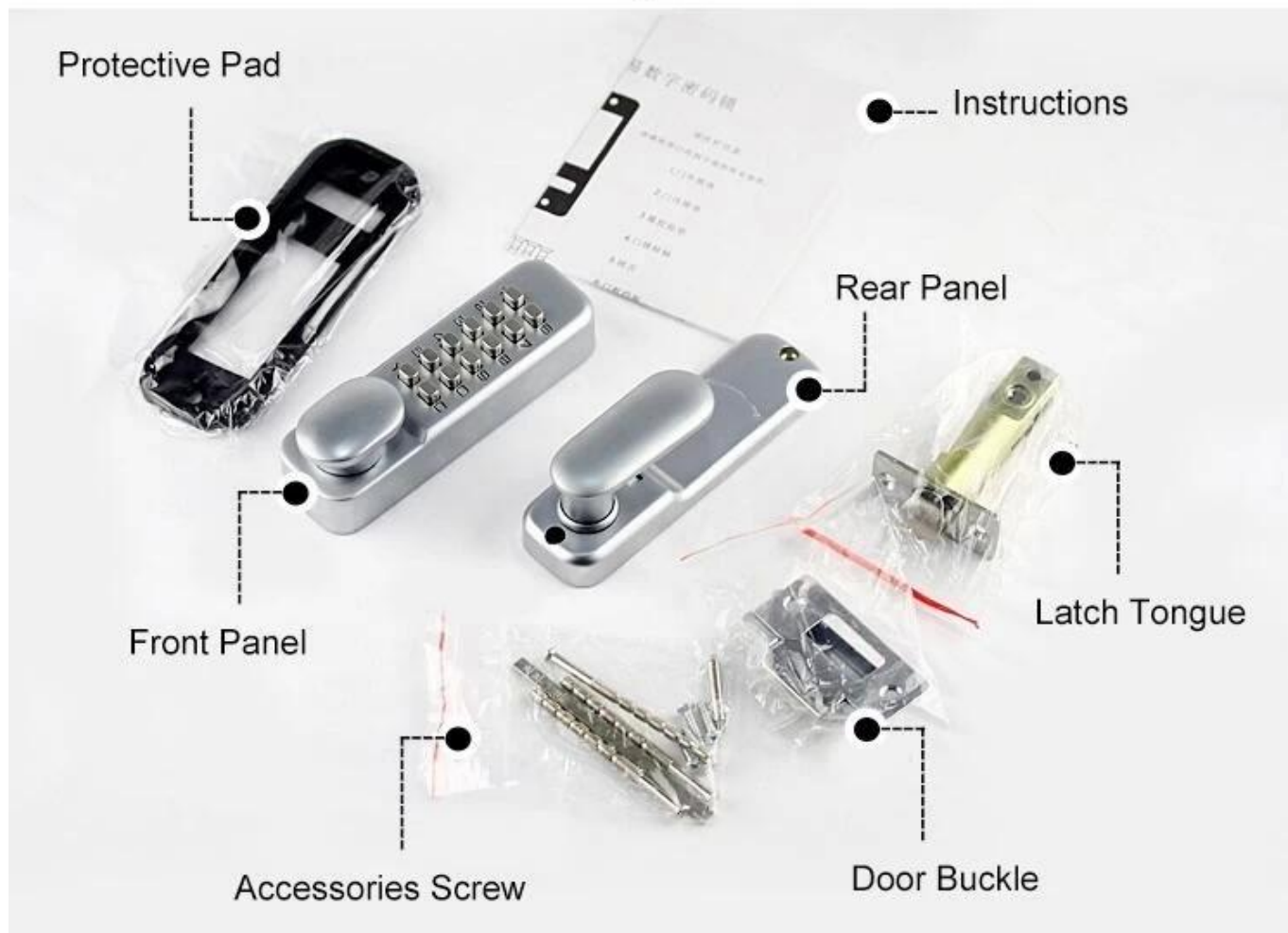

CONTACT US



Sincerely for your service

You are welcome to come to consult

Contact: Winnie Liang

Cellphone/Wechat/Whatsapp: +86 13602510930

Skype: udohow1

Email: info@udohow.com

Web: www.udohow.com

[Click Back Home](#)